



843 - 833 - 7840
lindsay@loblollydesigns.com

LOBLOLLY DESIGNS IS NOT AN ARCHITECTURAL FIRM AND RECOMMENDS THE CLIENT CONSULT EITHER WITH AN ARCHITECT OR ENGINEER TO CONFIRM STRUCTURAL LOADS, DIMENSIONS AND SQUARE FOOTAGES MAY VARY WITH ACTUAL CONSTRUCTION. THE SCOPE OF THE PROJECT MAY EVOLVE THROUGHOUT THE PROCESS DEPENDING ON UNKNOWN FACTORS THAT MAY ARISE.

LOBLOLLY DESIGNS IS NOT RESPONSIBLE FOR EXPENSES AND LIABILITY ASSOCIATED WITH THE CONSTRUCTION OF THE PROJECT. THE BUILDER SHALL VERIFY THAT SITE CONDITIONS ARE CONSISTENT WITH THESE PLANS BEFORE STARTING WORK. WORK NOT SPECIFICALLY DETAILED SHALL BE CONSTRUCTED TO THE SAME QUALITY AS SIMILAR WORK THAT IS DETAILED. ALL WORK SHALL BE DONE IN ACCORDANCE TO THE INTERNATIONAL BUILDING CODES AND LOCAL CODES.

TO THE BEST LOBLOLLY DESIGNS' KNOWLEDGE, THESE PLANS ARE DRAWN TO COMPLY WITH THE CLIENT'S AND BUILDER'S SPECIFICATIONS AND ANY CHANGES MADE AFTER FINAL SIGN-OFF WILL BE DONE AT THE CLIENT'S AND/OR BUILDER'S EXPENSE AND RESPONSIBILITY. THE BUILDER MUST CHECK ALL DIMENSIONS AND OTHER DETAILS PRIOR TO CONSTRUCTION AND BE SOLELY RESPONSIBLE THEREAFTER.

Bruce & Ashley Lowrey
1527 RADIAN ROAD
WILMINGTON, NC

drawn by
LMW

issue date
05 / 07 / 26

revision dates
05 / 18 / 26

05 / 20 / 26

ID.1

24 X 36

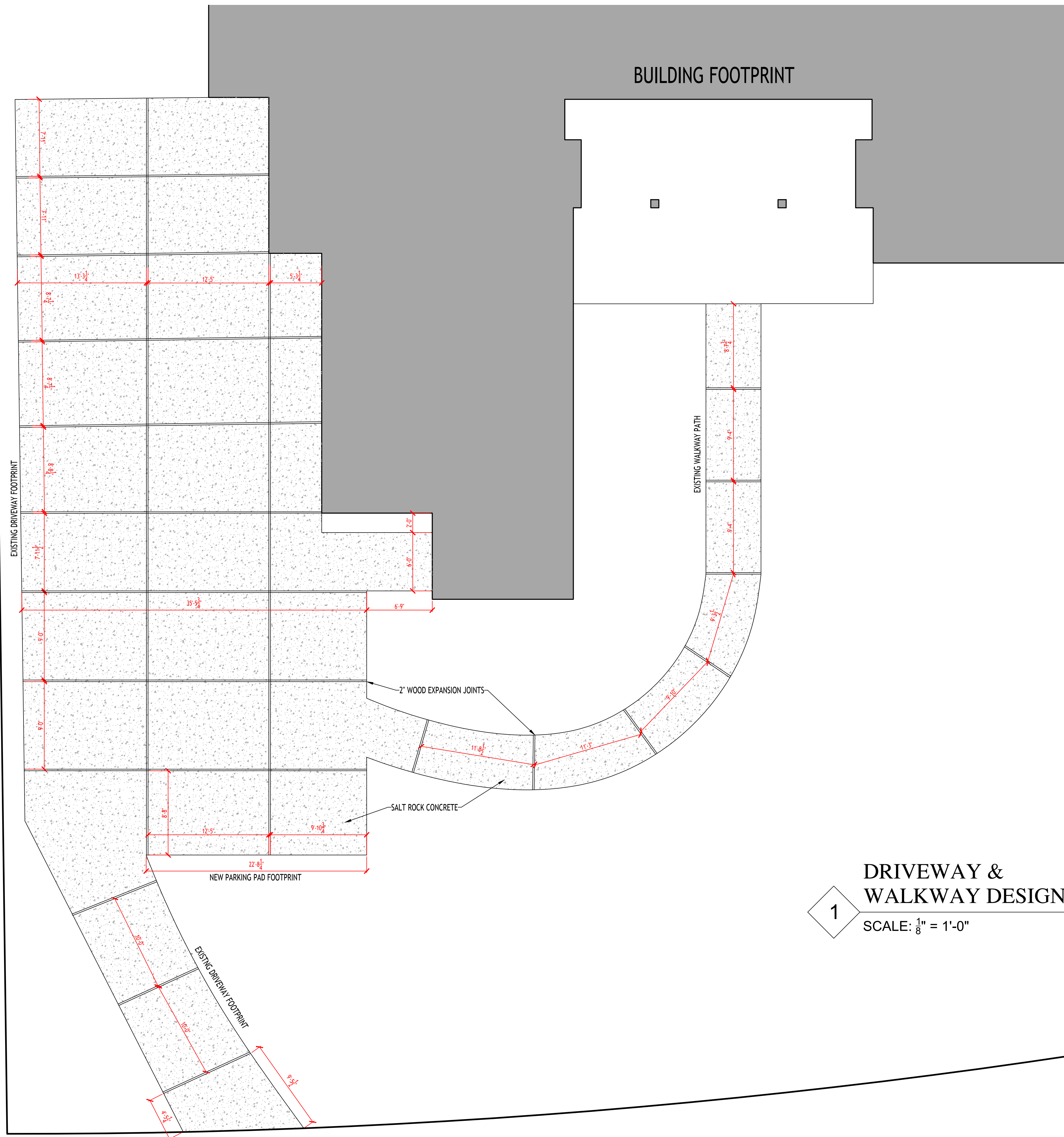

1
DRIVEWAY & WALKWAY DESIGN
SCALE: 1/8" = 1'-0"