

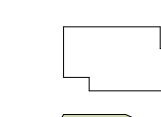
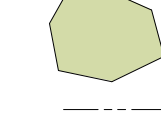
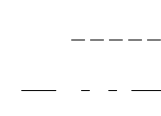

SITE LEGEND

-  NEW CONSTRUCTION
-  CONSERVATION RESOURCE AREAS
-  PROPERTY LINE
-  SETBACK LINE
-  CAMA LINES

AREA CALCULATIONS

TOTAL LOT AREA	23,538 sf
PERVIOUS AREA	14,257 sf
IMPERVIOUS AREA	9,281 sf
IMPERVIOUS %	39%

GENERAL NOTES

1. THE CONTRACTOR IS RESPONSIBLE FOR CONTACTING MISS UTILITY PRIOR TO BEGINNING CONSTRUCTION FOR LOCATION OF ALL UTILITY LINES. NOTIFY LANDSCAPE ARCHITECT IMMEDIATELY OF ANY CONFLICTS. CONTRACTOR IS RESPONSIBLE FOR DAMAGE TO EXISTING UTILITIES.
2. BASE INFORMATION HAS BEEN PROVIDED BY OWNER. 3NORTH ASSUMES NO RESPONSIBILITY FOR ACCURACY OF BASE INFORMATION. CONTRACTOR TO NOTIFY 3NORTH IMMEDIATELY OF ANY DISCREPANCIES IN BASE INFORMATION AND EXISTING FIELD CONDITIONS.
3. ALL WALKS SHALL HAVE A MINIMUM CROSS SLOPE FOR POSITIVE DRAINAGE AND SHALL NOT EXCEED 2% CROSS SLOPE UNLESS APPROVED BY OWNER/ARCHITECT.
4. EXPANSION JOINTS SHALL OCCUR WHERE PAVED SURFACES MEET WALLS AND WHERE HORIZONTAL SURFACES MEET VERTICAL SURFACES, OR WHERE OTHERWISE NOTED ON LAYOUT PLAN. CONTROL JOINTS AS SHOWN ON LANDSCAPE ARCHITECTS PLANS.
5. CONTRACTOR TO VERIFY EXISTING ELEVATIONS AND UTILITY LOCATIONS (INCLUDING WATER, SEWER, DRAINAGE, AND MANHOLE LOCATIONS).
6. ALL EXISTING TREES SHOWN TO BE PRESERVED. SEE GRADING AND DRAINAGE CONTROL PLAN BY LANDSCAPE ARCHITECTS FOR TREE PROTECTION DEVICES.
7. CURVILINEAR PATHS AND ROADS TO BE STAKED IN THE FIELD FOR APPROVAL BY THE LANDSCAPE ARCHITECT PRIOR TO CONSTRUCTION.
8. SEE LANDSCAPE ARCHITECT'S PLAN FOR ALL NOTES RELATED TO GRADING, PLANTING AND IRRIGATION.

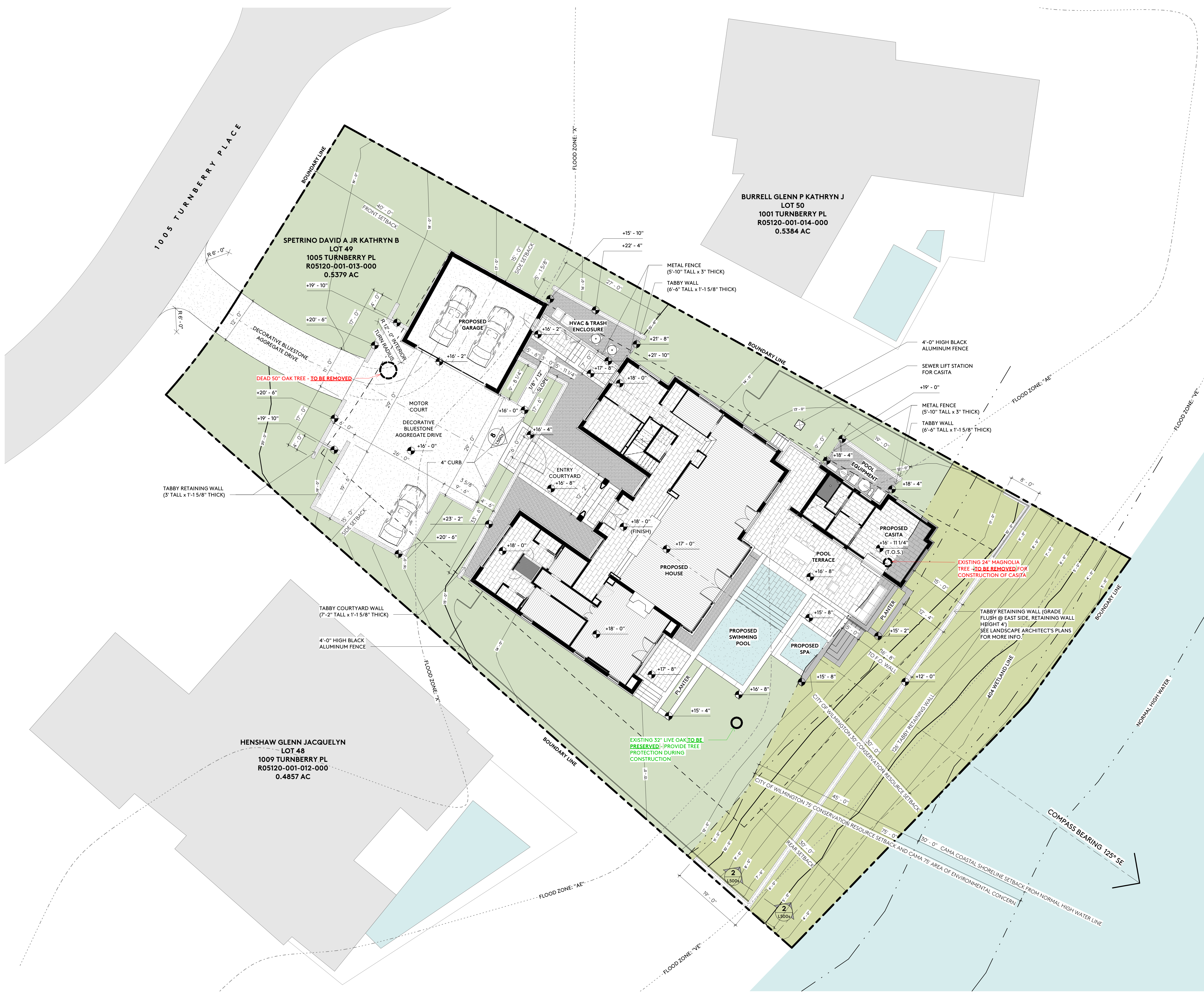

REVISIONS

RESIDENCE FOR M/M DAVID & KATHRYN SPETRINO
 1005 TURNBERRY PLACE
 WILMINGTON, NORTH CAROLINA 28405

LANDFALL PACKAGE - THIRD SUBMISSION

17 OCTOBER 2025



©2025
 www.3north.com
 804 232 8900

SITE PLAN 1
 1" = 10'-0"

SURVEY INFORMATION

TRANSYSTEMS - BOUNDARY AND TOPOGRAPHIC SURVEY BY MILES O. MCCALL III, DATED TO 2/11/2016, REVISED 6/11/24

SPETRINO RESIDENCE
FINISH
CATALOGUE

1005 TURNBERRY PLACE

SPETRINO RESIDENCE | FINISH CATALOGUE | 6 OCTOBER 2025



CONTENTS

RENDERING

ARRIVAL VIEW
WATER FRONT VIEW

SITE

CRUSHED BLUESTONE AGGREGATE
DRIVEWAY
PARKING COURT
SECONDARY WALK

TECHO BLOC PAVERS
ENTRY WALKWAY
GARAGE BREEZEWAY
POOL TERRACE & COPING
SPA TERRACE & COPING
PRIMARY BEDROOM TERRACE

TABBY
SITE WALLS

POWDER COATED ALUMINUM
FRONT GATE
HVAC & TRASH ENCLOSURE
POOL EQUIPMENT

ROOF PANEL SYSTEM
PERGOLA

BUILDINGS

PAINTED BRICK
MAIN HOUSE WALLS
CASITA WALLS
GARAGE WALLS

WINDOWS - MARVIN MODERN
MAIN HOUSE
CASITA
GARAGE

EXTERIOR DOORS - MARVIN MODERN SERIES
MAIN HOUSE
CASITA
GARAGE

EXTERIOR DOORS - FLEETWOOD 3000-T
MAIN HOUSE

EXTERIOR DOORS - CLOPAY CANYON RIDGE
GARAGE

PREFINISHED STANDING SEAM METAL ROOF
MAIN HOUSE
CASITA
GARAGE

EXTERIOR LIGHT FIXTURE
MAIN HOUSE
GARAGE
CASITA

SHUTTERS
GARAGE
MAIN HOUSE

POOL
WATERLINE
PLASTER

This Finish Catalogue by 3north, PLLC in 2025, is prepared exclusively for Mr. and Ms. Kathryn and David Spetrino
All content © 3North 2025.

This study may not be photocopied, scanned, archived, or retained electronically,
or reproduced in any form, without written permission from 3north.



RENDERING ARRIVAL VIEW

SPETRINO RESIDENCE | FINISH CATALOGUE | 6 OCTOBER 2025



RENDERING WATER FRONT VIEW

SPETRINO RESIDENCE | FINISH CATALOGUE | 6 OCTOBER 2025

- DRIVEWAY
- PARKING COURT
- SECONDARY WALK

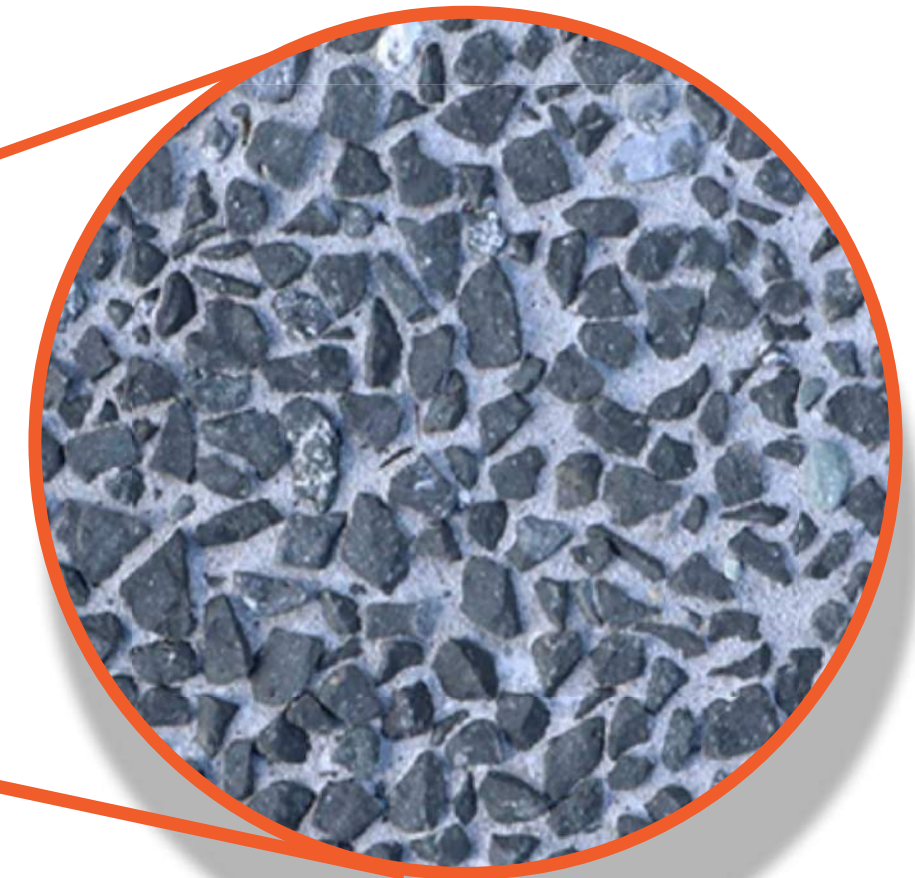

SITE CRUSHED BLUESTONE AGGREGATE

SPETRINO RESIDENCE | FINISH CATALOGUE | 6 OCTOBER 2025





-SITE WALLS

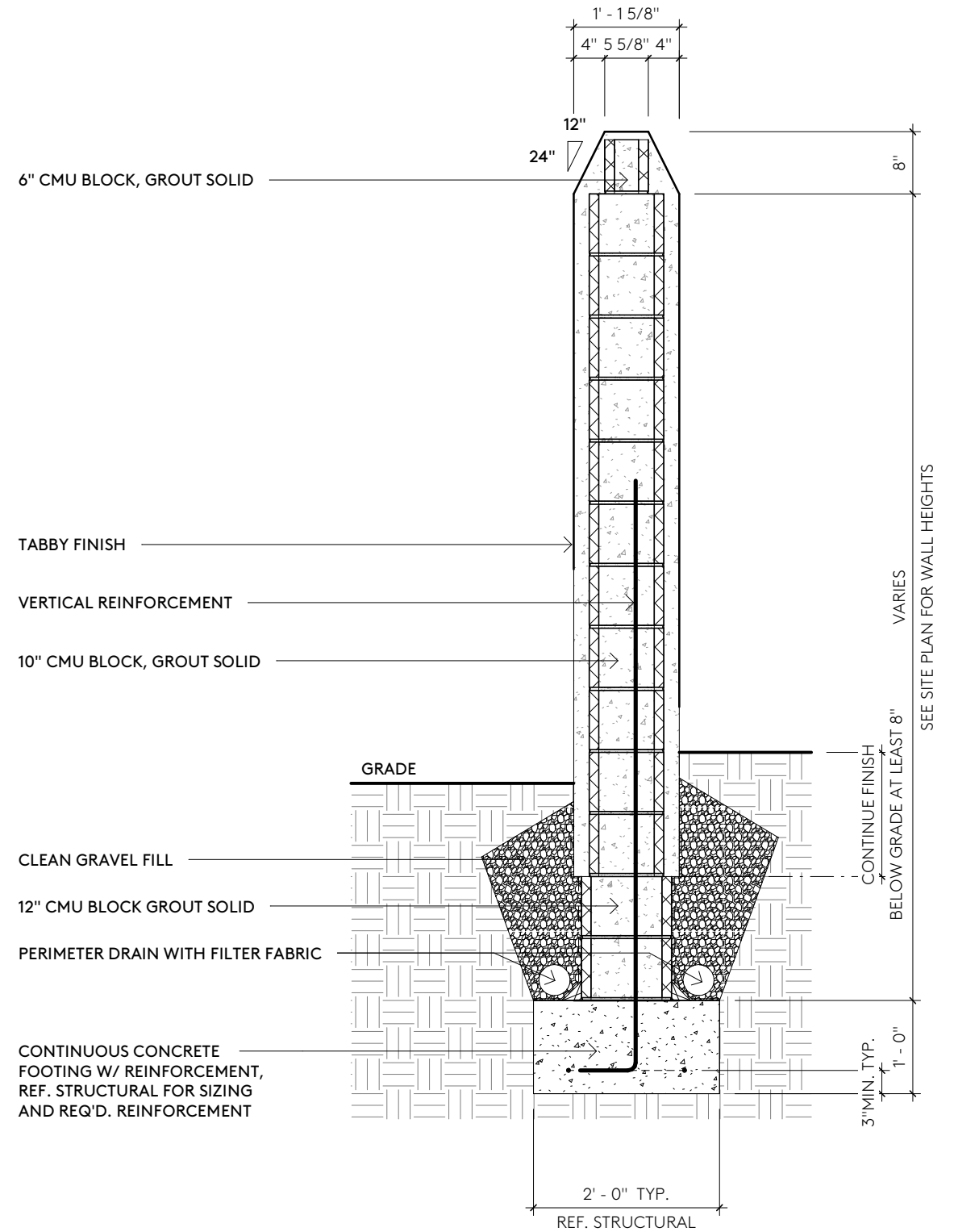

SITE TABBY

SPETRINO RESIDENCE | FINISH CATALOGUE | 6 OCTOBER 2025

LANDSCAPE WALL SECTION DETAIL

3/4" = 1'-0"

1



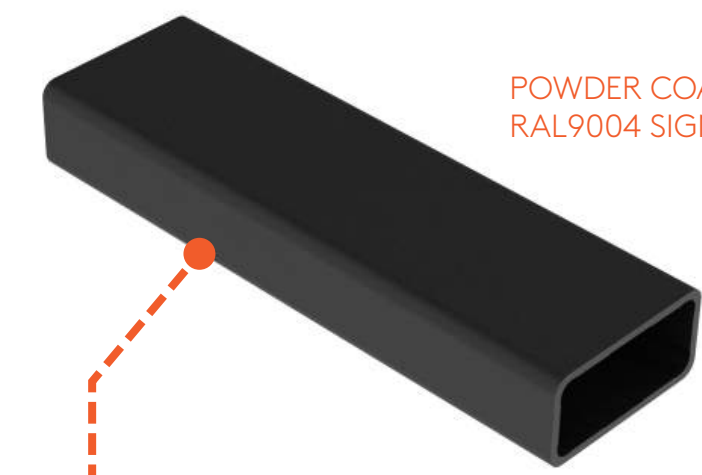
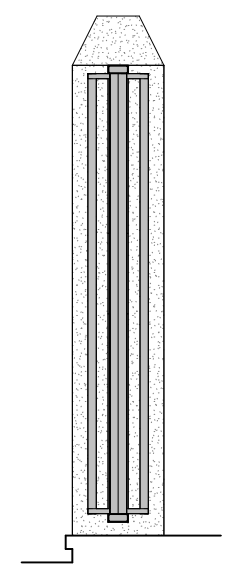
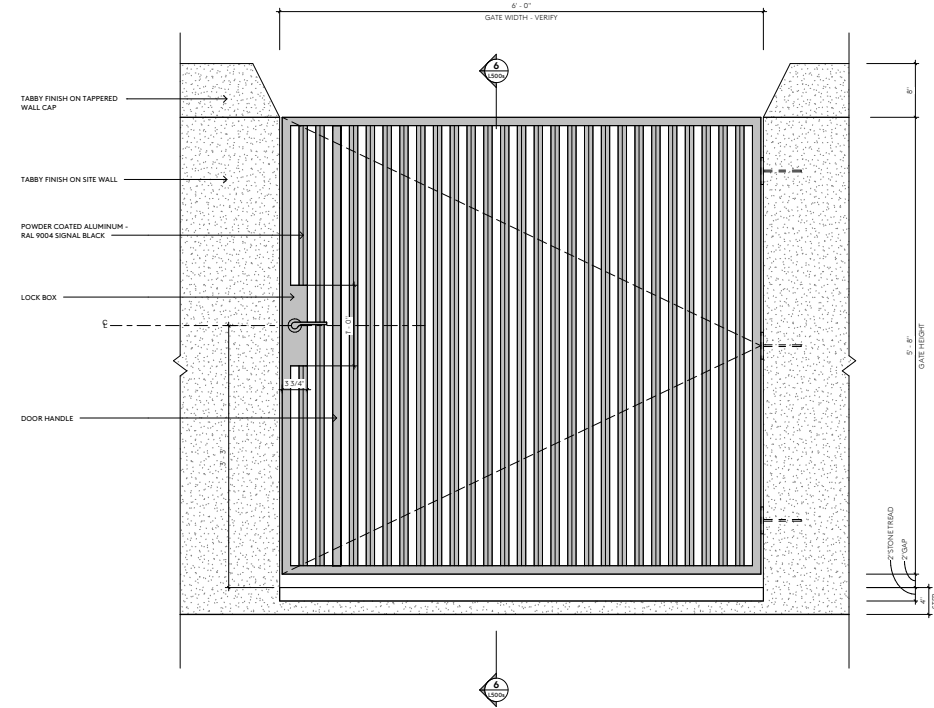

POWDER COATED ALUMINUM - RAL9004 SIGNALBLACK FINISH

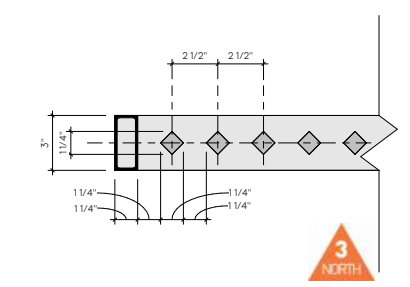
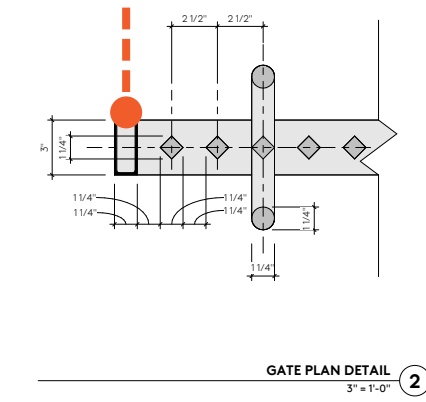
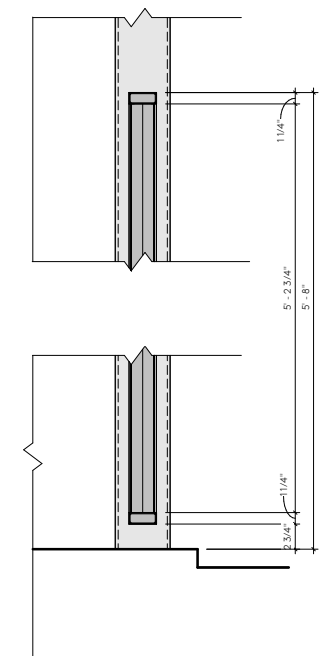
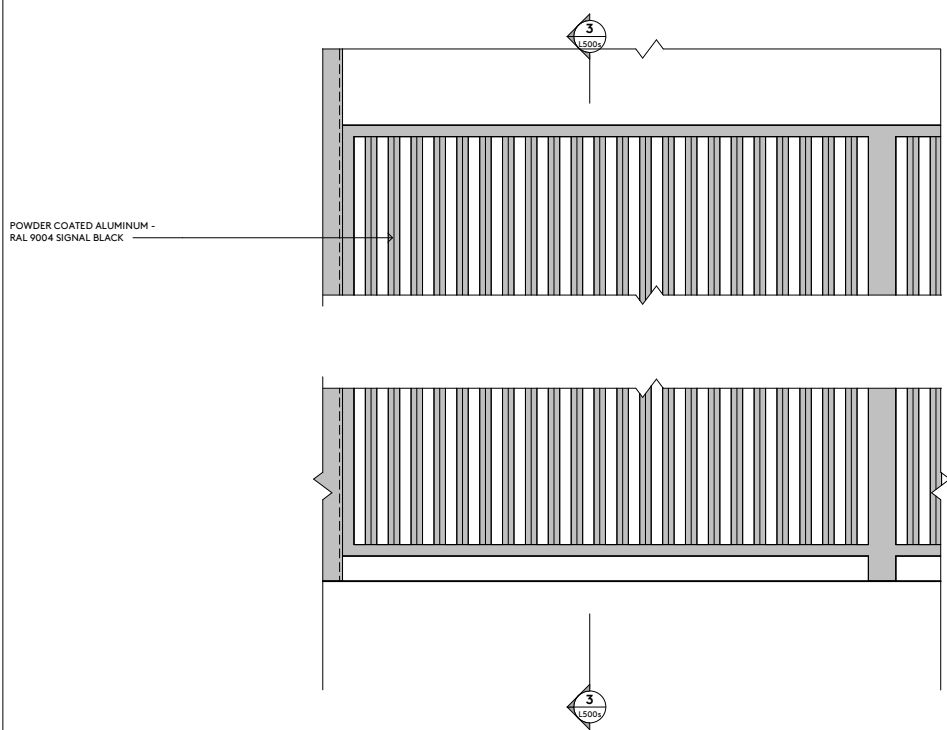

SITE POWDER COATED ALUMINUM



-PERGOLAS

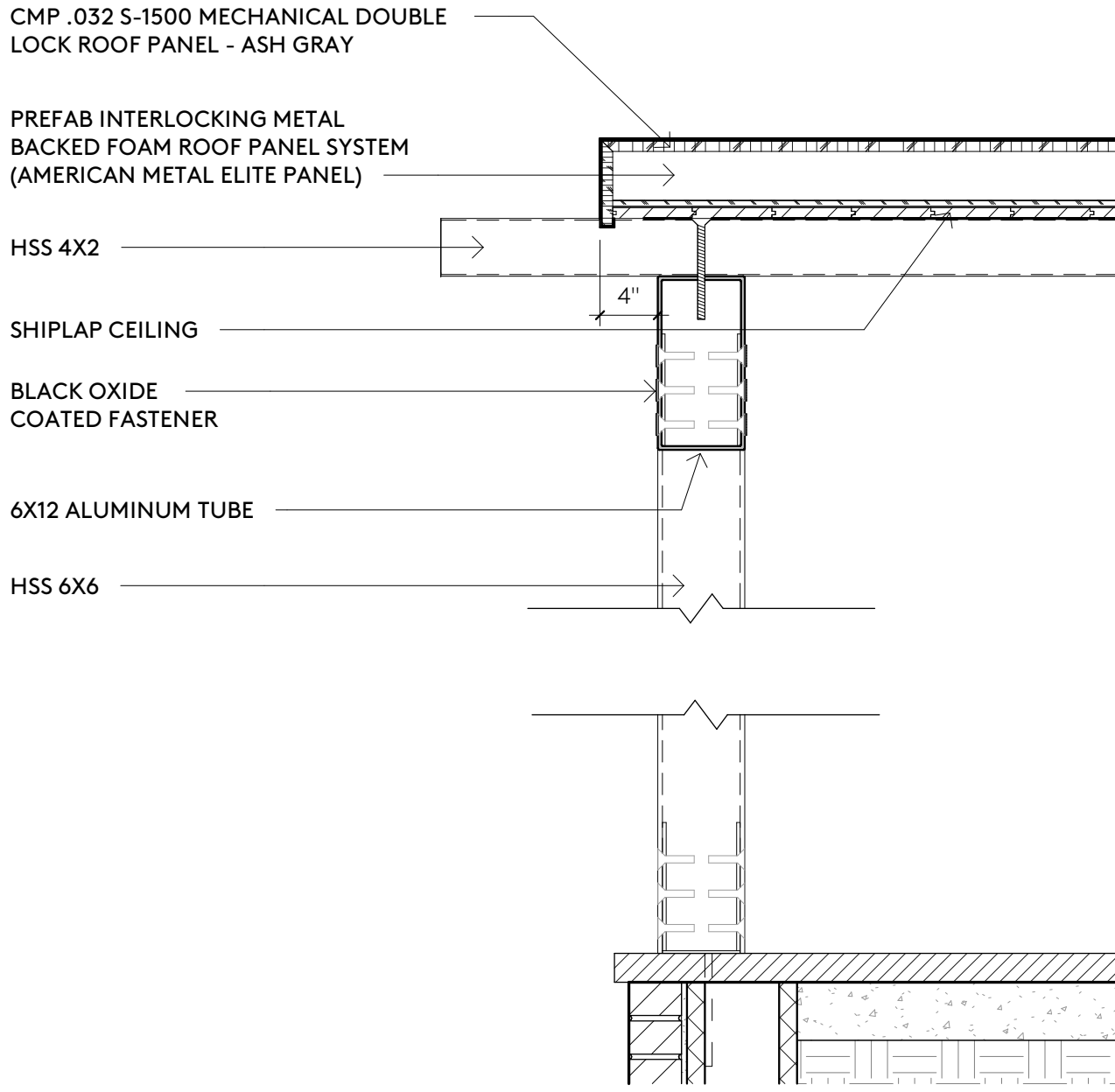
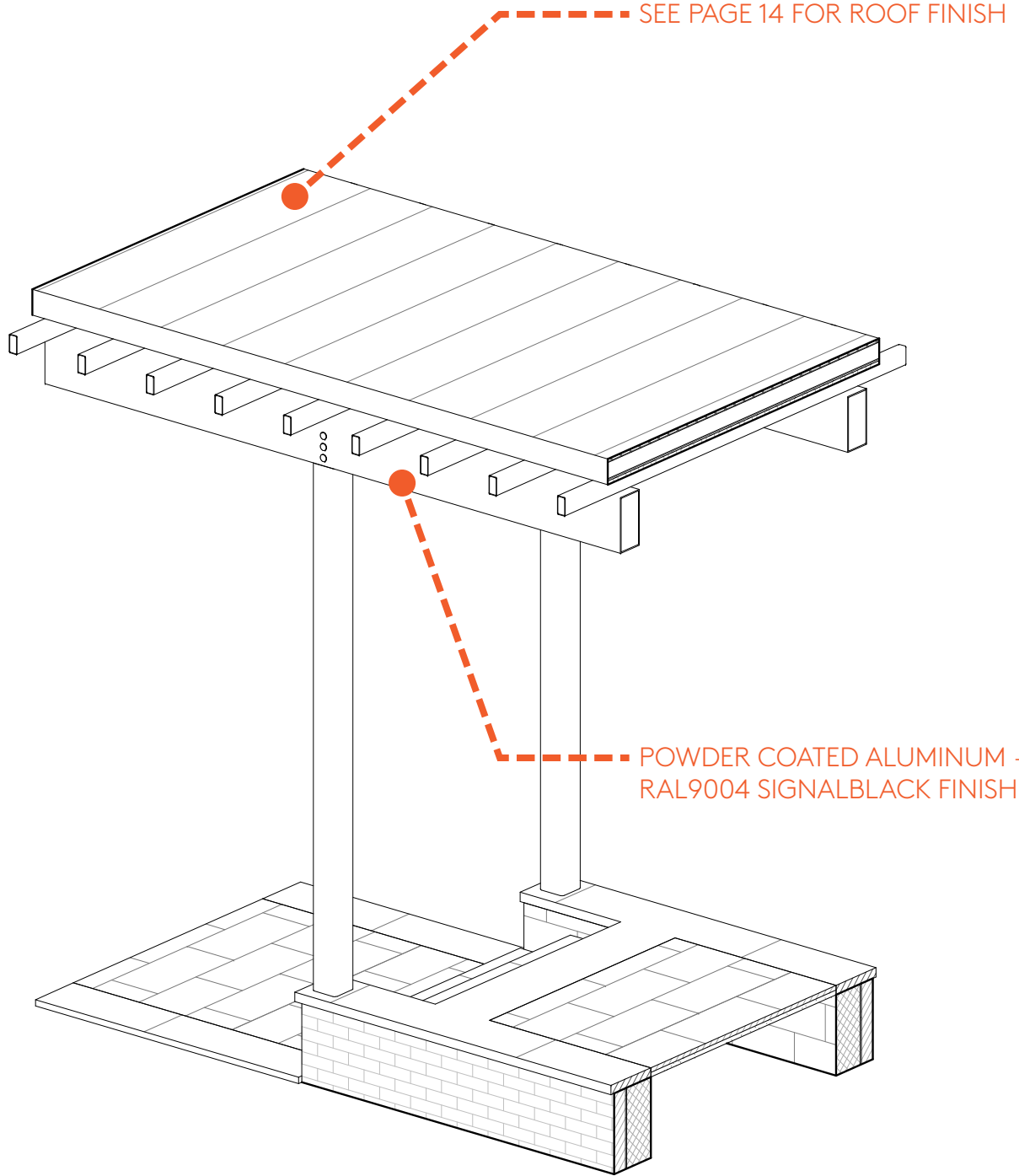

SITE CUSTOM PERGOLA DETAIL

SPETRINO RESIDENCE | FINISH CATALOGUE | 6 OCTOBER 2025



MASONRY MINERAL PAINT
MANUF: BENJAMIN MOORE
COLOR: ETIQUETTE AF-50



- MAIN HOUSE
- CASITA WALLS
- GARAGE WALLS

GENERAL SHALE:

- PHOENIX
- MANUFACTURED IN: MONCURE, NC



February 11, 2025

General Shale

Email: Jesse.Healy@Generalshale.com

Job: [REDACTED]

General Contractor: [REDACTED]

PBC

GENERAL SHALE BRICK

The brick shown below manufactured by General Shale Brick, Inc., main office located in Johnson City, Tennessee, comply with the physical requirements for Type HBA, Class H40V, Grade SW, under ASTM C652 (Latest Revision) Standard Specifications for Hollow Brick.

Type Brick: Lightweight Engineer Size Phoenix
Cleaning Code "B"

Manufacturing Plant: Moncure General Shale Brick, Inc.
300 Brick Plant Road
Moncure, NC 275593

Jim Bryja P.E., S.E.- Manager of Engineering Services

Cc: Plant Manager

BUILDING PAINTED BRICK

SPETRINO RESIDENCE | FINISH CATALOGUE | 6 OCTOBER 2025



Section Details: Operating Push-out

Scale: 3" = 1' 0"

- MAIN HOUSE
- CASITA
- GARAGE

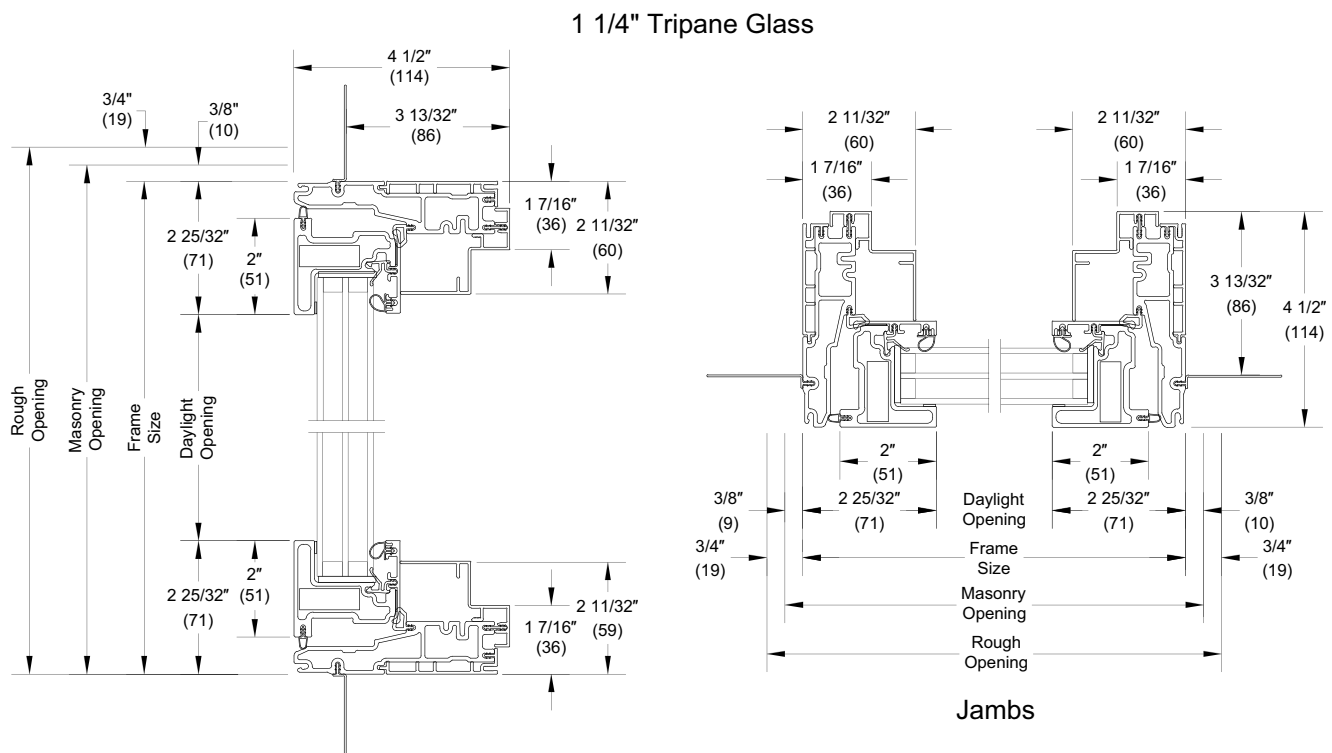
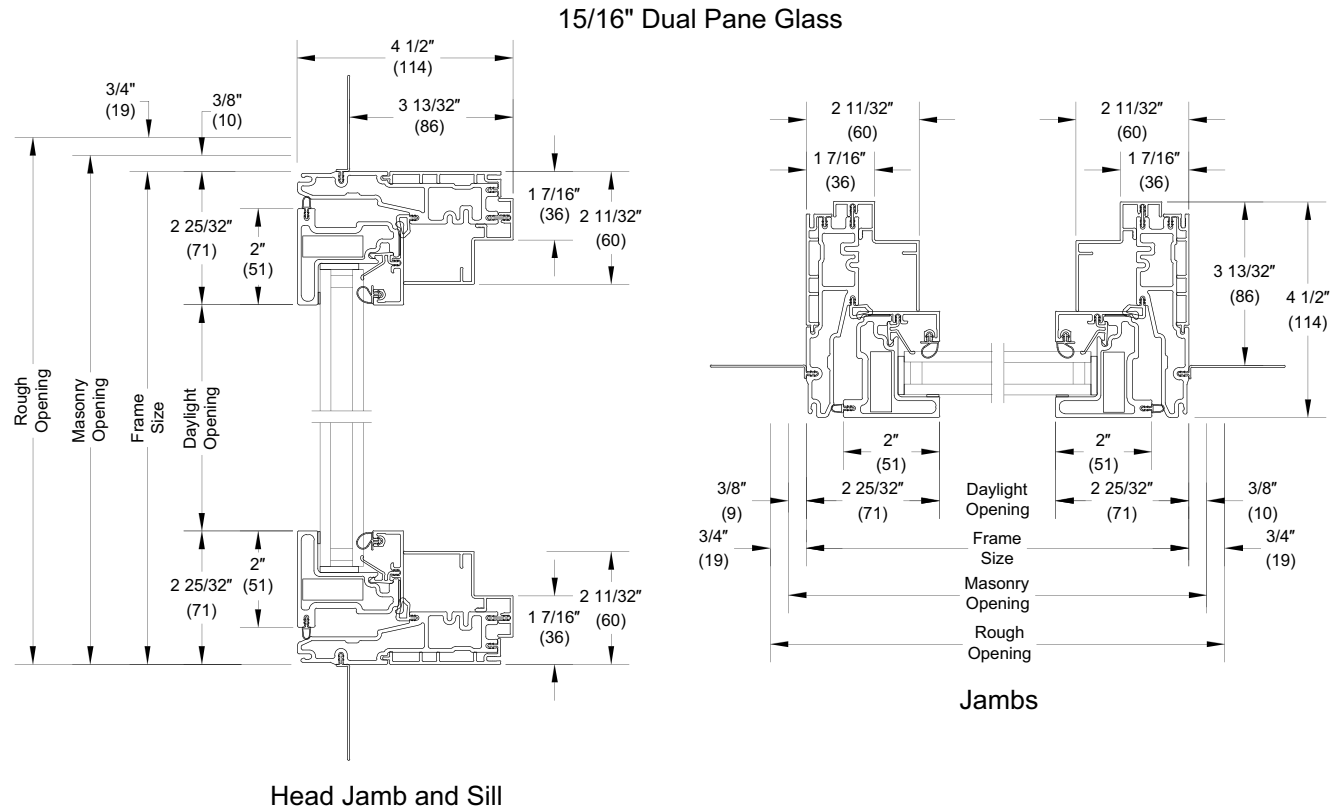



Modern Swinging Doors

Inswing Section Details: Operating (Dual Pane)

Scale: 3" = 1' 0"

- MAIN HOUSE
- CASITA
- GARAGE

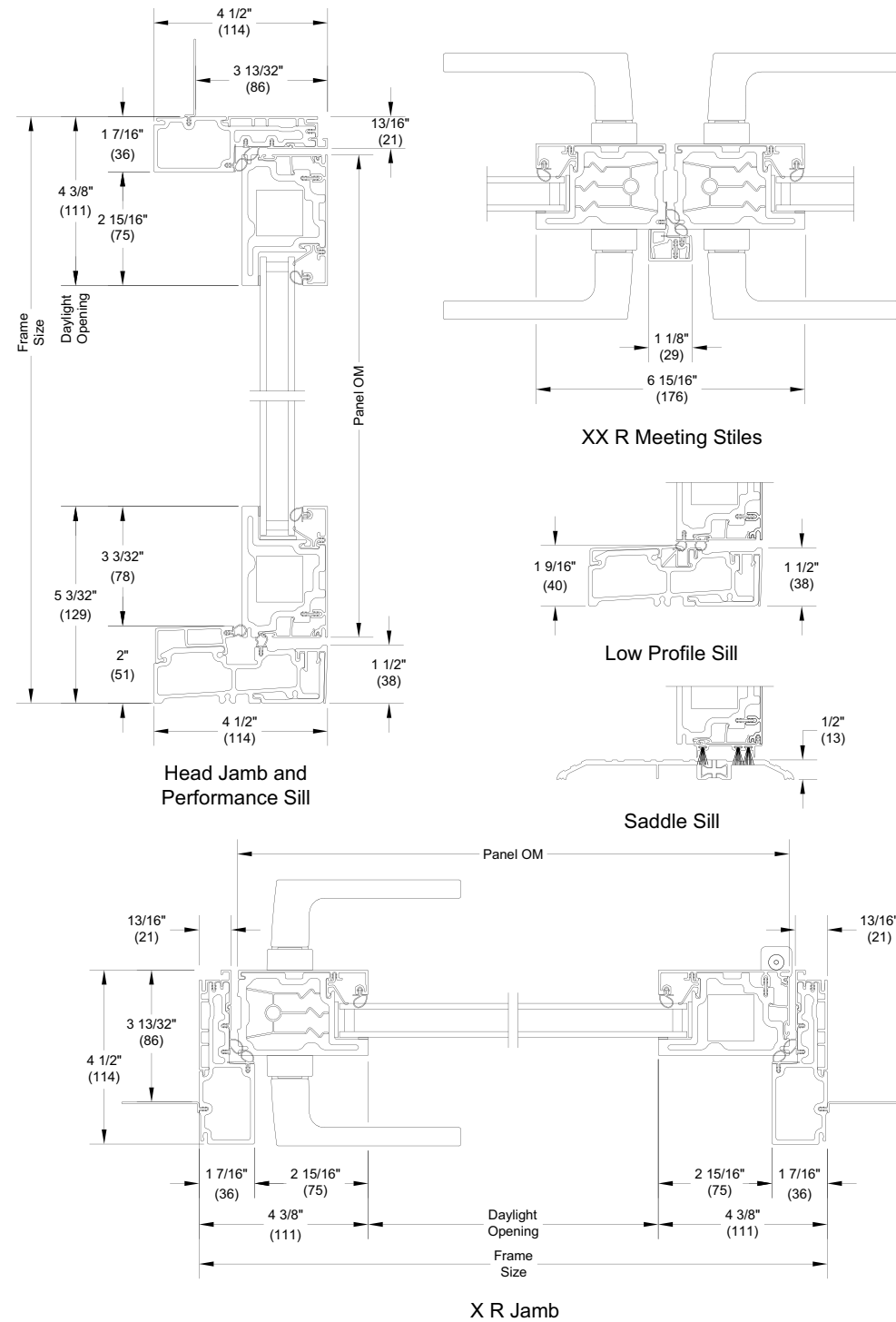

BUILDING EXTERIOR DOORS-MARVIN

SPETRINO RESIDENCE | FINISH CATALOGUE | 6 OCTOBER 2025



0 1 2 3 4 5 6
SCALE: 1/4
(USE RULER TO SCALE DIMENSIONS IN INCHES)

SLIDING DOOR DETAILS
1" INSULATED GLAZING SHOWN

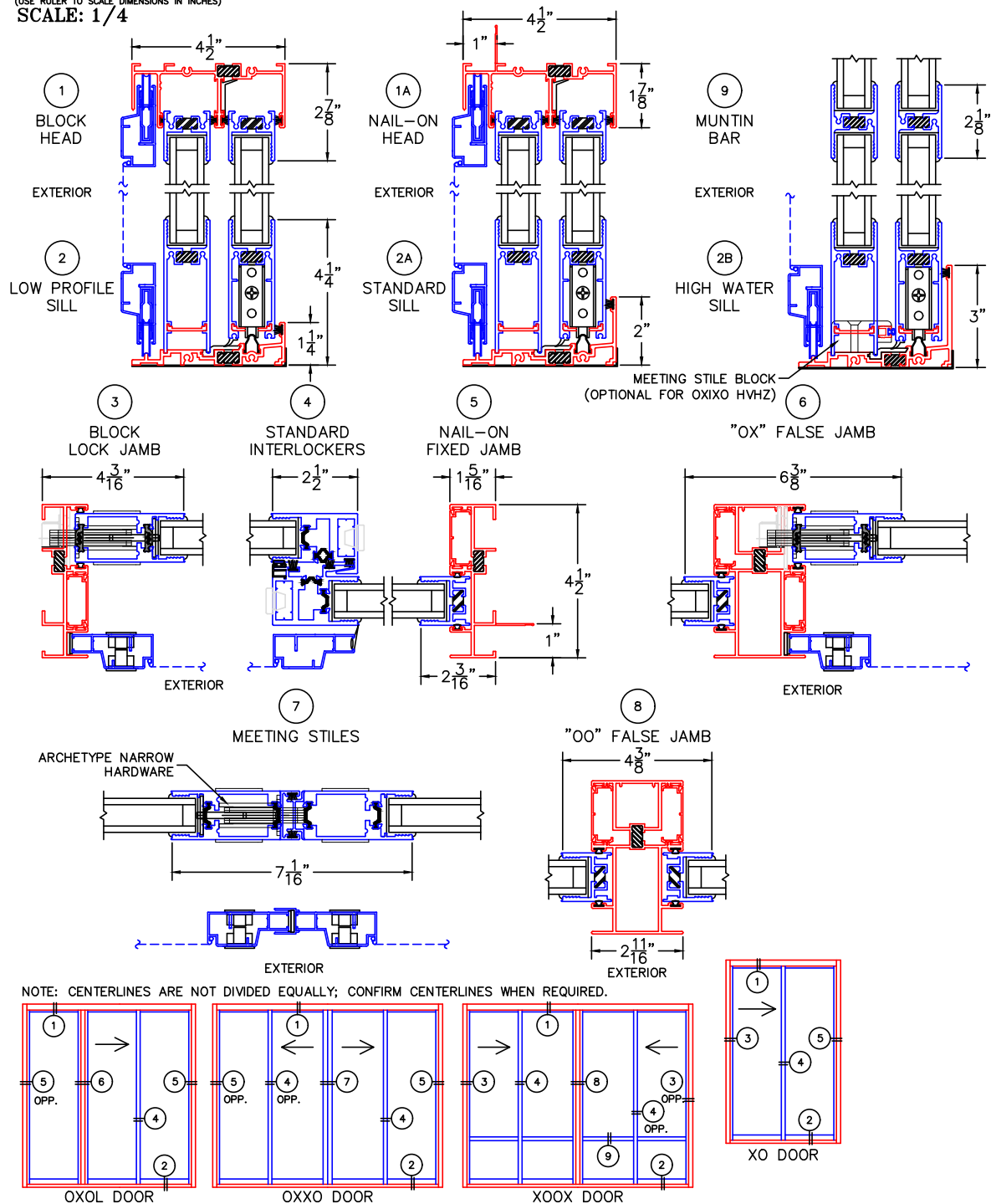

-GLASS PENETRATION: 11/16"



PRODUCT FEATURES

Standard Features

- Stock Anodized Finish: Black (Class 1) or Clear (Class 1)
- 1" Insulated Glass with Dark Bronze Spacer
- 6063 T-6 Extruded Aluminum
- Poured & De-bridged Thermal Barrier
- Strut Thermal Barriers (Interlockers)
- 4-1/2" Deep Nail-on Frame
- Stainless Steel Assembly Screws
- Head Filler (s)
- 2" Height Threshold with **Stainless Steel Track**
- Aluminum Sill Pan (Non-Thermal)

- Authentic Precision Bearing Stainless Steel Tandem Rollers** (1-7/8" Diameter)
- Equal Sized Glass
- Archetype Stainless Steel Hardware**
Actuator Height 46"
- Adjustable Stainless Steel Strike**
- Stainless Steel Dust Box
- Wrap Around Glazing
- Extruded Screen Door with **UltraVue** Mesh (Phifer.com)

Optional Features

- (See CAD Details for more options)
- Finish:
- Kynar 70% Paint (50% for dark colors, ex. Black)
 - Class 1 Custom Anodize (Light Bronze & Medium Bronze)
- Glazing: 1/4" & 9/16"
- 4-1/2" Deep Equal Leg (Block) Frame
 - 3" Height Threshold (High Weather Performance)
 - Wide or Archetype Fixed Stile
 - Unequal Sized Glass (Flush Stack)
 - High Performance Interlockers
 - High Performance Meeting Stiles
 - Side Lites (Field Mullied 3800-T)
 - Transoms (Field Stacked 3800-T)
 - Black Painted Archetype Hardware
 - Archetype Actuator Only
 - Archetype Lever**
 - Exterior or Interior Keyed Lock
 - Actuator Height: 54", 36" & 24"
 - Steel Look SDL**



Canyon Ridge® / Louver, Design 52, Shown Custom Painted in Sherwin-Williams SW 2739 Charcoal Blue with Louver Mahogany Cladding, Mahogany Overlays and REC14 Window Design. Photo Credit: Andy Frame Photography

DECORATIVE HARDWARE

Attractive black powder coated handles and step plates are provided standard to further enhance the Canyon Ridge® Design. Optional decorative hardware — including handles, operable L-keylocks and strap hinges, is also available.

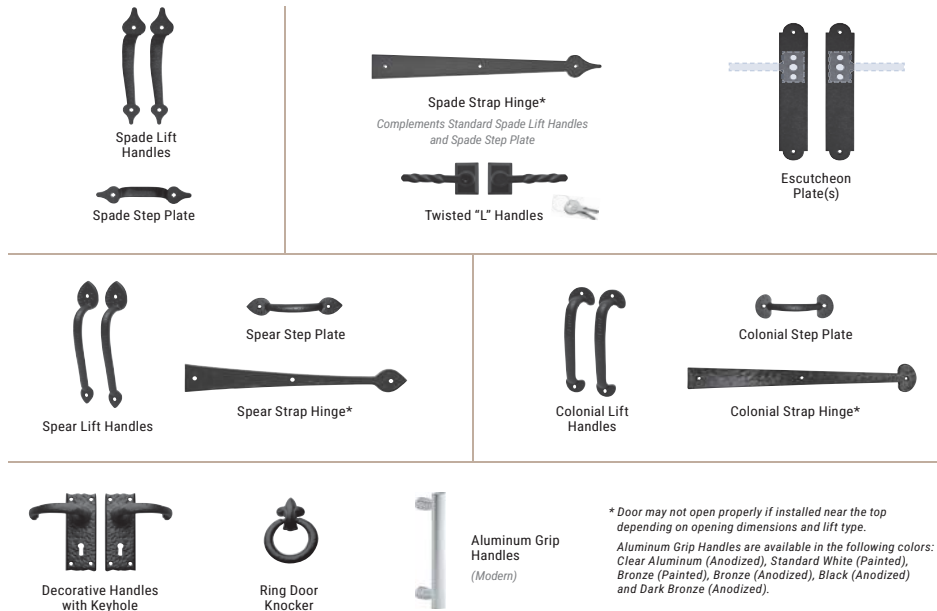

*Door may not open properly if installed near the top depending on opening dimensions and lift type. Aluminum Grip Handles are available in the following colors: Clear Aluminum (Anodized), Standard White (Painted), Bronze (Painted), Bronze (Anodized), Black (Anodized) and Dark Bronze (Anodized).

CANYON RIDGE® Louver

If you use more than one adjective to describe your home's style, we have the perfect transitional garage door for you. Versatile and unique, plantation style Canyon Ridge® Louver doors are a perfect complement to coastal cottages and colonial homes. They can also be a standout piece on traditional exteriors or modern farmhouses. Whatever your style, these doors add "wow" factor to your home. As with all Canyon Ridge doors, they are constructed with a durable, insulated steel core topped with horizontal faux-wood composite "slats". The result is a low-maintenance door with dimension and flair.

CUSTOM PAINT PROGRAM

Color Blast® offers more than 1,500 Sherwin-Williams® color options to complement your home. Clopay's durable two-part paint system has been thoroughly tested and is backed by a five-year warranty.



CLOPAYDOOR.COM | 17



-GARAGE



STYLE AND CONSTRUCTION

- 4 or 5-layer faux-wood louver doors with Intelllicore® polyurethane insulation. R-values from 18.4 to 20.4.
- Insulated glass styles include clear, frosted, seeded, rain and obscure. See page 16 for details.
- Removable clip-in window grilles for easy cleaning.
- Spade lift handles and step plates included. See page 17 for more options.

Calculated door section R-value is in accordance with DASMA TDS-163. Canyon Ridge® doors not applicable for new construction in California areas designated as "Fire Hazard Severity Zones".

DOOR DESIGNS

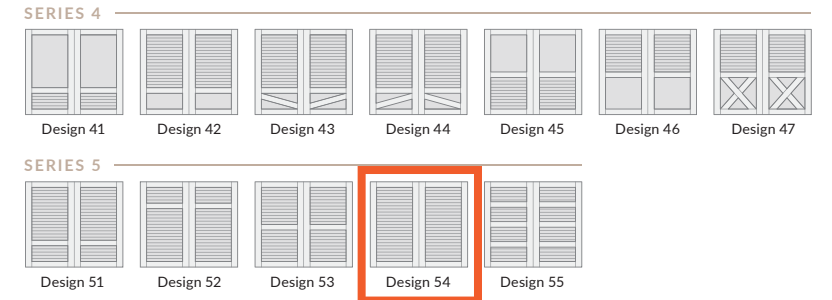

MATERIAL DESIGN OPTIONS

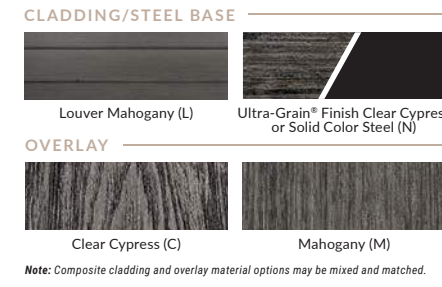

*Dark Finish not available in a base steel color on Design 41, 42, 43, 44, 45, 46 and 47. Bronze, Charcoal, Black and White Finish available on Mahogany cladding and overlay. Doors can be ordered for custom field painting. Note: Primed solid steel overlay stain color vary due to finishing process. Two-tone doors are available. To see all options go to: ezdoor.clopay.com. Steel surfaces have woodgrain texture. Due to the printing process, colors may vary. Order free color samples at clopaydoor.com. requestcolorsamples.

WINDOWS/TOP SECTIONS

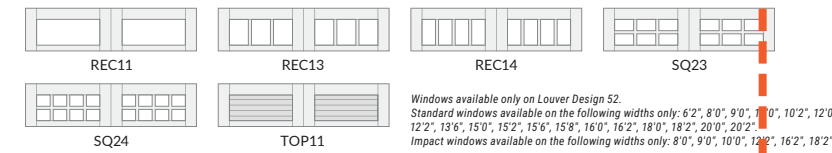

Windows available only on Louver Design 52. Standard windows available on the following widths only: 6'2", 8'0", 9'0", 10'0", 10'2", 12'0", 12'2", 13'6", 15'0", 15'2", 15'6", 15'8", 16'0", 16'2", 18'0", 18'2", 20'0", 20'2". Impact windows available on the following widths only: 8'0", 9'0", 10'0", 12'0", 16'2", 18'2".

BUILDING EXTERIOR DOORS-CLOPAY





CMP S-1500 PANEL

One of our most popular panel systems, the CMP S-1500 is consistently used on a wide variety of homes and architectural commercial projects. The mechanically crimped side seams can be single locked for most applications, or double locked when taking on blowing rain or snowy environments. This versatile panel can also be curved to fit even the most complicated barrel roofs. These attributes come together to make it perfect for both light commercial and residential applications.

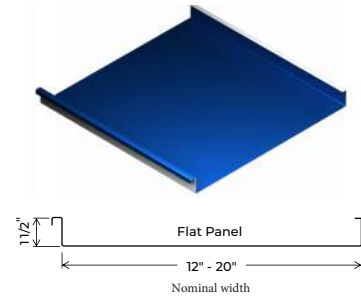

PANEL SPECIFICATIONS

- Widths – 12"- 20", 12" and 16" Standard
- Seam Height – 1.5" Standard
- 1" Seam Height available upon request
- Made to exact lengths
- Single or double locked
- Radius / Curved panels
- 40+ different color/coating options

MATERIALS AVAILABLE

- Steel – 24ga and 26ga
- Aluminum - .032" & .040"
- Copper – 16 oz

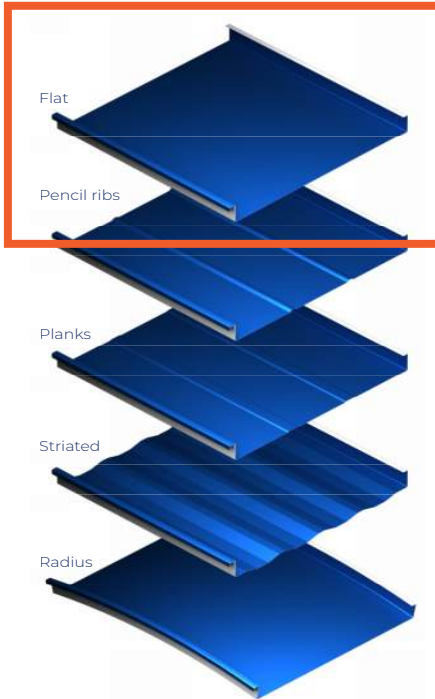
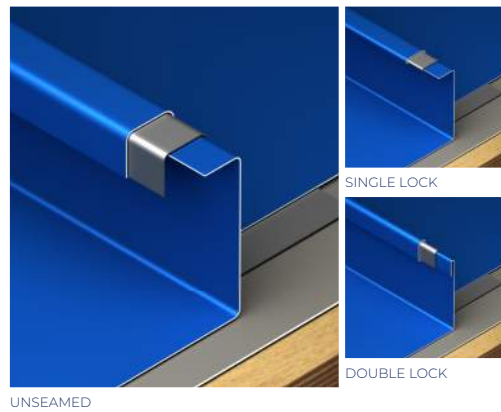

PANEL OPTIONS

Flat, Pencil Ribs, Planks
Striated, Radius / Curved

COLORS AND COATINGS

See all 40+ colors and coatings on the CMP or Alumaklad/Colorklad color charts at www.cmpmetalsystems.com

FINISH AND PRODUCT WARRANTIES

- High quality PVDF coating by Valspar
- Aluminum and Steel substrate up to 35 year warranty
- Contact us for more detailed information

INSTALLATION

Concealed fastener clip system
Mechanically seamed
Can be installed over steel or plywood decking with proper underlayment

MINIMUM SLOPE / ROOF PITCH

2:12



TESTING

- ASTM E-1592 Wind Uplift Resistance
- ASTM E1680 Air Infiltration
- ASTM E1646 Water Penetration
- TAS 100-95 Wind Driven Rain
- UL 580-06 Wind Uplift Resistance
- UL 1897-2012 Wind Uplift Resistance
- UL 2218 Hail Impact
- IBHS "Fortified & Safe Home" Approval
- Florida Product Approval 6IG20-3 HVHZ
- PA 125 Dade County Wind Uplift
- TAS 125-03 Application Standard
- TAS 110-00 Accelerated Weathering
- ASTM E 84 Surface Burning Class "A"
- ASTM G 155 / Salt Spray ASTM B 117

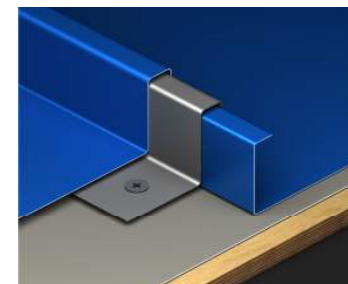

29/26 GAUGE COLOR CHART

Construction Metal Products inc.

CMP manufactures a variety of metal roof and wall panels in 26 gauge and/or 29 gauge material. Please see the back of this chart to view the profiles that are available.

CMP's 40-year Silicon Polyester paint system, with Cool Roof Technology, provides solar reflectance ratings to meet today's Energy Star requirements. The 40-year paint system and galvalume steel guarantees a winning combination of weather-tested paint performance and superior corrosion resistance.

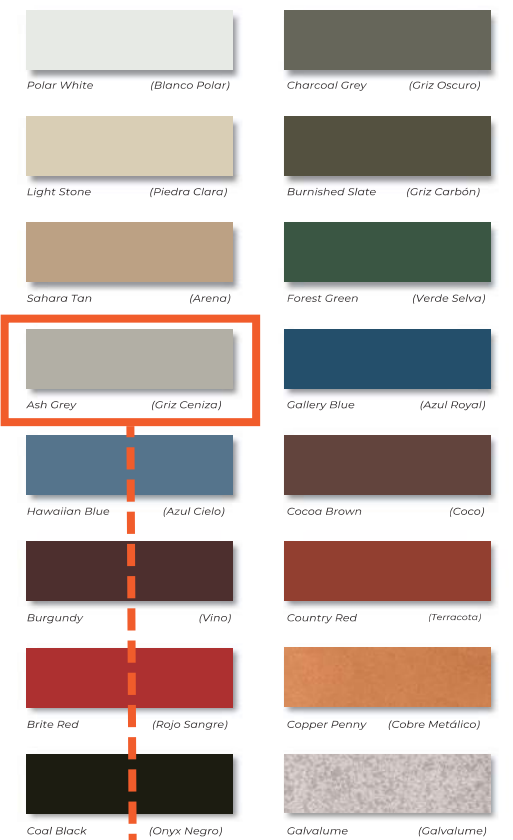

Colors shown here are as accurate as the printing process permits. Slight variations should be expected for the actual coil product.

2204 West Front Street Statesville, NC 28677 | 704-871-8704 | www.cmpmetalsystems.com

Oil canning is an inherent aspect within metal roofing, and not a cause for rejection.

2204 West Front Street Statesville, NC 28677 | 704-871-8704 | www.cmpmetalsystems.com

Oil canning is an inherent aspect within metal roofing, and not a cause for rejection.

Statesville, NC • Myrtle Beach, SC • Charleston, SC
www.cmpmetalsystems.com • 704-871-8704 • questions@cmpmetalsystems.com



BUILDING PREFINISHED STANDING SEAM

TEAR SHEET



Fresno Large 3/4 Gas Wall Lantern

Item # CHO 2551BLK-CG

Designer: Chapman & Myers

Height: 20.25"

Width: 7"

Extension: 8.25"

Backplate: 6" x 18" Rectangle

Finishes: BLK, SC

Glass Options: CG

Lightsource: Gas Burner

Wattage: 800 BTU

Weight: 12 Pounds

Note: Powder-Coated Aluminum | Brass Details and Iron Hardware | Natural Gas Only | Professional Installation Only | Limited Lifetime Warranty | Brass Will Patina

-MAIN HOUSE

-GARAGE

-CASITA

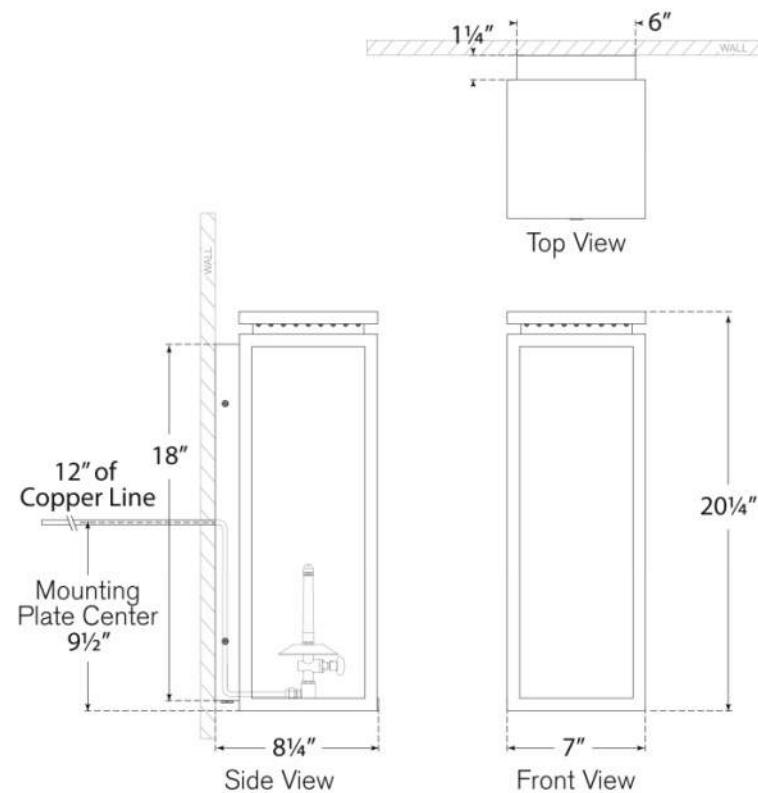

VISUAL COMFORT & Co.



BUILDING EXTERIOR LIGHT FIXTURE



SW1: 2-3/8" Fixed Louver Shutter

Sturdy and substantial. Set at a 20-degree pitch, these extra wide louvers make a grand statement and are full of contemporary appeal. In addition to its application as exterior shutters, these make a graceful transition inside as closet and cabana doors.

Cross Section:



Available In:

Endurian (Exclusive PVC), Premium Wood

SW1 Specifications

Stiles	2-1/2"
Top Rail	2-1/2"
Middle Rail(s)	4-1/4"
Bottom Rail	3" to 5"
Stile/Rail Thickness	1-5/16"
Louver Pitch	20 degrees
Louver Spacing	2-1/4" on center
Louver Thickness	3/8"

NO MIDRAIL

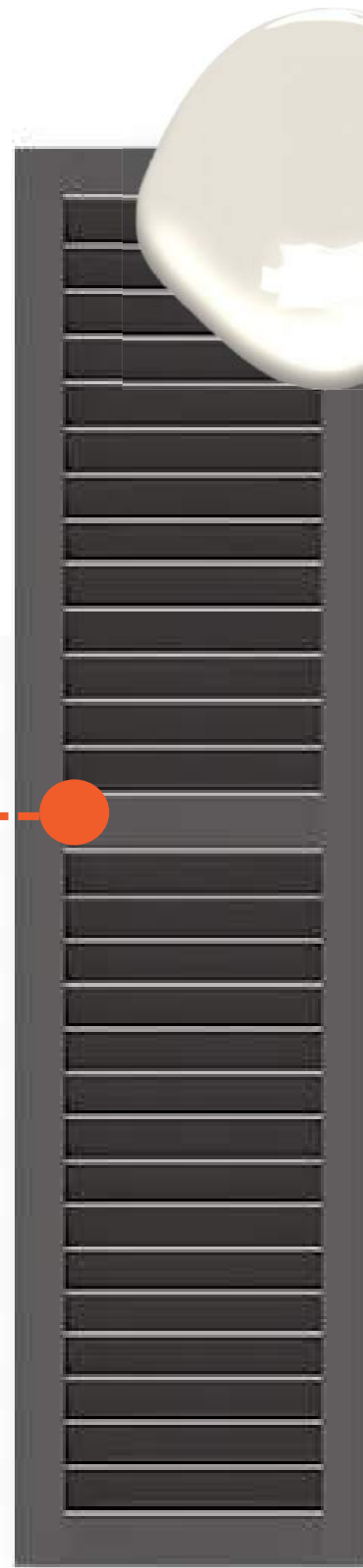

SHUTTER COLOR
BENJAMIN MOORE
ETIQUETTE AF-50



-GARAGE
-MAIN HOUSE

Weight	N/A
Length	10"
Hinge Offset	1/2", 1-1/2", 2-1/4"
Sleeve Diameter	3/8"
Thickness	1/8"
Width	1-3/4"
Finish	Black Powder Coated
Material	Stainless Steel
Strength	Standard Duty

Weight	N/A
Mount Type	Lag, Plate, Sill
Head Height	5-1/2"
Finish	Black Powder Coated
Material	Steel, Stainless Steel

Weight	N/A
Offset	1", 2", 3", 4"
Pin Diameter	1/2"
Plate Thickness	3/16"
Plate Width	1-1/2"
Plate Length	4"
Finish	Black Powder Coated
Material	Steel, Stainless Steel
Strength	Heavy Duty
Mount Type	Plate

BUILDING SHUTTERS

SPETRINO RESIDENCE | FINISH CATALOGUE | 6 OCTOBER 2025





-WATERLINE TILE
 DAL TILE COLORWAVE
 COLOR "SMOKED PEARL" CW17

MOSAIC				COLOR WAVE™ GLASS TILE AND MOSAICS & BLENDS																					
SIZES				FINISHES																					
	2x4 Rect. Tile (5" x 4") (127 mm x 102 mm)	Thickness 5/16"	Sq. Ft./ Case	4.00	Pieces/ Case	32																			
	2x4 Square Tile (5" x 5") (127 mm x 127 mm)	Thickness 5/16"	Sq. Ft./ Case	10.00	Pieces/ Case	32																			
	2x4 Square Tile with Grout (5" x 5") (127 mm x 127 mm)	Thickness 5/16"	Sq. Ft./ Case	10.50	Pieces/ Case	30																			
	2x4 Square Tile with Grout and Sealant (5" x 5") (127 mm x 127 mm)	Thickness 5/16"	Sq. Ft./ Case	11.00	Pieces/ Case	30																			
	2x4 Square Tile with Grout and Sealant (with GFI) (5" x 5") (127 mm x 127 mm)	Thickness 5/16"	Sq. Ft./ Case	11.50	Pieces/ Case	30																			
	2x4 Square Tile with Grout and Sealant (with GFI and Anti-Slip) (5" x 5") (127 mm x 127 mm)	Thickness 5/16"	Sq. Ft./ Case	12.00	Pieces/ Case	30																			
	2x4 Square Tile with Grout and Sealant (with GFI and Anti-Slip and Anti-Static) (5" x 5") (127 mm x 127 mm)	Thickness 5/16"	Sq. Ft./ Case	12.50	Pieces/ Case	30																			
APPLICATIONS				PERFORMANCE CHARACTERISTICS																					
<ul style="list-style-type: none"> Dry Deck - Interior Floor Wet Deck - Interior Floor Wet Deck - Exterior Floor Pool Deck Pool Deck (with Grout and Sealant) Pool Deck (with Grout and Sealant and GFI) Pool Deck (with Grout and Sealant and GFI and Anti-Slip) Pool Deck (with Grout and Sealant and GFI and Anti-Slip and Anti-Static) 				<table border="1"> <thead> <tr> <th>Property</th> <th>Value</th> <th>Rating</th> </tr> </thead> <tbody> <tr> <td>Water Absorption</td> <td>1.0%</td> <td>A-100</td> </tr> <tr> <td>Flexural Strength</td> <td>15,000 psi</td> <td>B-100</td> </tr> <tr> <td>Compressive Strength</td> <td>150,000 psi</td> <td>A-100</td> </tr> <tr> <td>Impact Resistance</td> <td>100 ft-lb</td> <td>B-100</td> </tr> <tr> <td>Acoustic Coefficient</td> <td>0.02</td> <td>B-100</td> </tr> </tbody> </table>				Property	Value	Rating	Water Absorption	1.0%	A-100	Flexural Strength	15,000 psi	B-100	Compressive Strength	150,000 psi	A-100	Impact Resistance	100 ft-lb	B-100	Acoustic Coefficient	0.02	B-100
Property	Value	Rating																							
Water Absorption	1.0%	A-100																							
Flexural Strength	15,000 psi	B-100																							
Compressive Strength	150,000 psi	A-100																							
Impact Resistance	100 ft-lb	B-100																							
Acoustic Coefficient	0.02	B-100																							
<p>APPLICATION NOTES:</p> <ul style="list-style-type: none"> Always follow manufacturer's instructions for installation and maintenance. Use a non-slip mat for pool decks. Use a non-slip mat for pool decks. 				<p>NOTES:</p> <ul style="list-style-type: none"> Some tiles are variations of the same color and finish. Use of a water line with this tile is recommended. For additional information, please contact your local distributor. 																					



-WATERLINE
 -PLASTER

StoneScapes Micro: French Gray



Water Color: Light Gray

StoneScapes Micro French Gray pool finish creates light gray water color and is comprised of modified white Portland cement which has been colored with French gray pigment, natural quartz aggregate and a specialty blend of glass bead aggregates.

BUILDING POOL

SPETRINO RESIDENCE | FINISH CATALOGUE | 6 OCTOBER 2025

